

# FaceStation F2

Fusion Multimodal Terminal



Unrivaled  
Face Recognition  
Performance



Best-in-class  
Multimodal Device



Contactless Solution  
for the New Normal



Robust Device Security and  
Data Encryption

**suprema**  
SECURITY & BIOMETRICS



## Unrivaled face recognition performance by Fusion Matching

FaceStation F2 boasts exceptional authentication accuracy achieved by the fusion matching of visual and infrared(IR) face recognition.

\*False Acceptance Rate(FAR) of 1 in 10 billion.



- Suprema's unique algorithm optimizes IR and visual face recognition to produce the industry's best face recognition and anti-spoofing performance
- Proven track record of authentication performance regardless of user ethnicity and face changes powered by deep learning algorithm

## Best-in-class multimodal with various credentials

FaceStation F2 offers a wide range of authentication options including face, mobile access, fingerprint and cards.

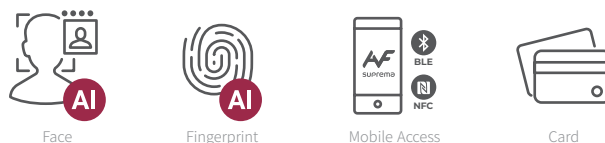

- Register up to 100,000 users for fingerprints authentication and 50,000 users for face authentication
- Supports dual frequency access cards, NFC and BLE-based Mobile Access Cards
- Template-on-Card allows authentication via biometric data stored in cards

**AI** Deep learning-based AI algorithm applied for live face/fingerprint detection



## Contactless solution for new standards of safety and hygiene

FaceStation F2 meets the needs of the post-pandemic world with remote and contactless solution.

- Detects and limits access of users not wearing masks
- Face recognition of users wearing masks
- Remote user enrollment through profile photo uploads
- Combines with Suprema Thermal Camera to identify users with elevated skin temperature

## Robust device security and data encryption

FaceStation F2 is equipped with security measures to protect user data.

- Highest level of device security including secure booting process
- Encrypts all biometric credentials and personal information



## System Configurations

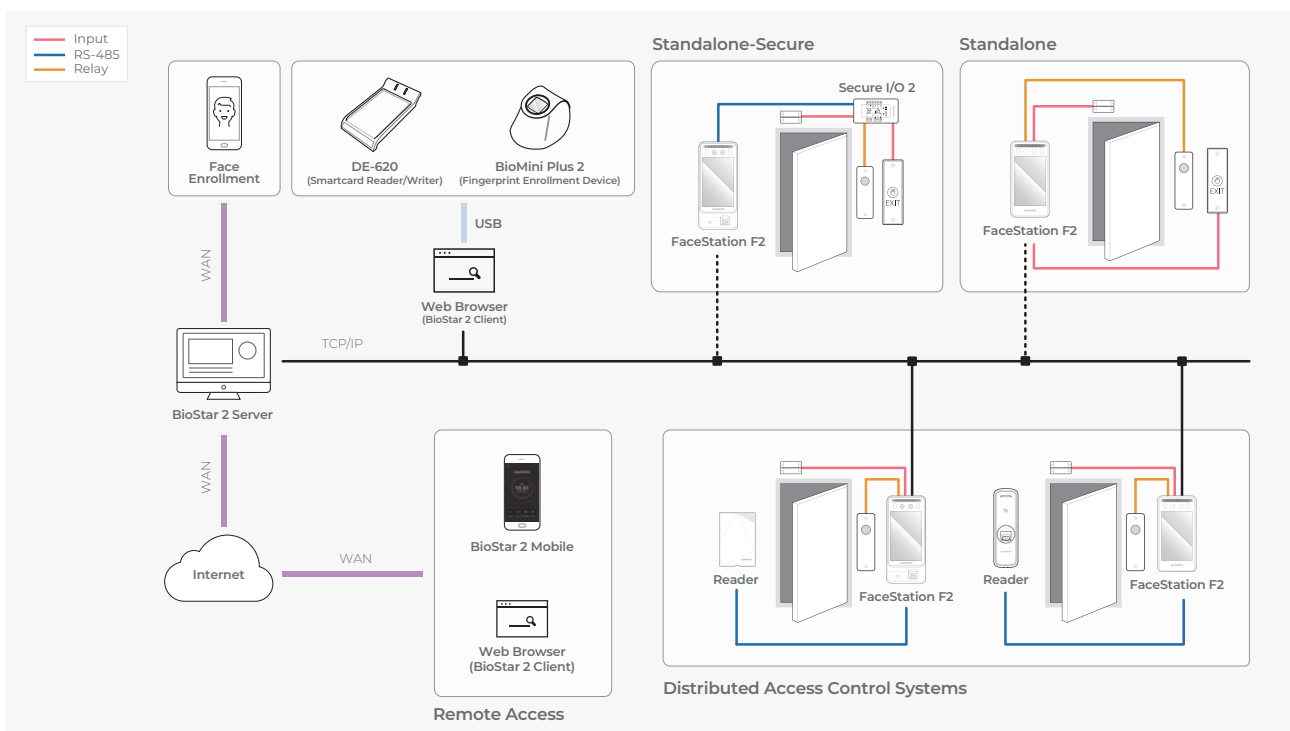

## Product Specification



Category	Feature	FSF2-DB	FSF2-AB	FSF2-ODB	
Credential	Biometric	Face		Face, Fingerprint	
	RF Option	125kHz EM & 13.56MHz MIFARE, MIFARE Plus, DESFire EV1/EV2 <sup>(1)</sup> , FeliCa	125kHz EM, HID Prox & 13.56MHz MIFARE, MIFARE Plus, DESFire EV1/EV2 <sup>(1)</sup> , FeliCa, iCLASS SE/SR/Seos	125kHz EM & 13.56MHz MIFARE, MIFARE Plus, DESFire EV1/EV2 <sup>(1)</sup> , FeliCa	
	RF Read Range <sup>(2)</sup>	EM/MIFARE/DESFire : 50 mm (2"), FeliCa: 30 mm (1.2")			
	Mobile	NFC, BLE			
General	CPU	1.8 GHz Dual Core + 1.4 GHz Quad Core			
	Memory	16GB Flash + 2GB RAM			
	LCD Type	7" IPS color LCD			
	LCD Resolution	800 x 1280 pixels			
	Sound	16bit			
	Operating Temperature	-20°C ~ 50°C (-68°F ~ 122°F)			
	Operating Humidity	0% ~ 80%, non-condensing			
	Dimension (W x H x D)	119.8mm x 223mm x 23.5mm (4.7" x 8.8" x 0.9")		119.8mm x 268.4mm x 49.7mm (4.7" x 10.6" x 1.9")	
	Weight	Device	585g		670g
		Bracket (Including washer and bolt)	181g		205g
IP Rating	IP65				
Certificates	CE, FCC, KC, RoHS, REACH, WEEE				
Face	Recognition Distance	0.5m ~ 1.3m (19.7" ~ 51.2")			
	Recognition Height	140cm ~ 190cm (55.1" ~ 74.8")			
	Matching Speed	Less than 0.5 sec			
	Live Face Detection (Anti-Spoofing)	Supported			
Fingerprint	Image Dimension			300 x 400 pixels	
	Resolution			500 dpi	
	Template			SUPREMA / ISO19794-2, ANSI-378	
	Extractor / Matcher	N/A		MINEX certified and compliant	
	Sensor Certificates			FBI PIV and FBI Mobile ID FAP20	
	Live Fingerprint Detection			Supported (Deep learning-based)	
Capacity	Max. User (1:1) * Based on one face/fingerprint enrollment per user	100,000			
	Max. User (1:N) * Based on one face/fingerprint enrollment per user	Face: 50,000		Face: 50,000 Fingerprint: 100,000	
	Max. Text Log	5,000,000			
	Max. Image Log	50,000			
Interface	Ethernet	10/100 Mbps, auto MDI/MDIX			
	RS-485	1ch Host or Slave (Selectable)			
	Wiegand	1ch Input or Output (Selectable)			
	TTL Input	2ch Inputs			
	Relay	1 Relay			
	USB	USB 2.0 (Host)			
	Tamper	Supported			
Power	Voltage: DC 12V ~ DC 24V Current: Max. 2.5 A * Use a 24V/2.5A adapter. Must follow the product manual when using a 12V adapter.				

<sup>(1)</sup> DESFire EV2 cards are supported by having backward compatibility of DESFire EV1 cards. CSN and smart card functions are compatible with FaceStation F2.

<sup>(2)</sup> RF read range will vary depending on the installation environment.



### Suprema Inc.

17F Parkview Tower, 248, Jeongjail-ro, Bundang-gu, Seongnam-si, Gyeonggi-do, 13554, Republic of Korea

T +82 31 783 4502 www.supremainc.com



For more information visit our website below by scanning the QR code.  
<https://www.supremainc.com/en/about/contact-us.asp>